

Check

Ensure you have enough product, of the same batch to complete the job.

Safety

To minimise fire hazards never hang wallpapers over polystyrene veneers. Surfaces painted prior to 1960 may contain lead pigments: special precautions should be taken during preparations. Isolate electrical power, via the main fuse box, when decorating around switches, plugs and light fittings. Always work in a well ventilated environment.

Preparation of walls

Cure areas of damp and/or mould at source. Make sure your wall surfaces are clean, smooth, dry and free from any loose material. Absorbent (new) surfaces should be sized. Roughen up gloss painted surfaces with glass paper. Freshly painted surfaces should be left for at least 3 days before papering over. Always cross line your walls before hanging your decorative paper. Use a good quality adhesive mixed to the manufacturers instructions.

Note

This product can be installed in single or multiple panels.

Hanging Dado Panels (not on stairs). Please note if your project includes stairs you should read the supplementary instructions for stairs before beginning.

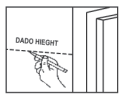

- 1 If dado rails are not installed strike a straight line horizontally across the wall at the desired dado height

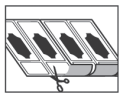

- 2 Cut the desired number of panels. (NB 1 full panel is 64cm in width)



- 3 Use a good quality adhesive suitable for heavy wallcoverings.

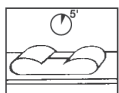

- 4 Lightly fold the paper onto itself and allow to soak for at least 5 minutes.

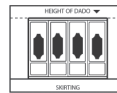

- 5 Position the paper, aligning the top of the design with the horizontal line or under the dado rail. It is important to ensure the paper is hung the correct way up as the bottom part of the panel is purposefully designed to be trimmed.

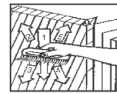

- 6 Brush the paper down and out from the centre to the edges expelling any paper bubbles and ensuring maximum contact with the wall.

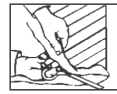

- 7 Once the paper is in position trim off the excess at the skirting board.



- 8 Remove any excess paste with a damp sponge immediately.

Hanging Dado Panels on stairs - Supplementary information. When intending to hang panels on stairs it is important to start the whole project (including lower hall) at point 'PLUMB A' as shown below.

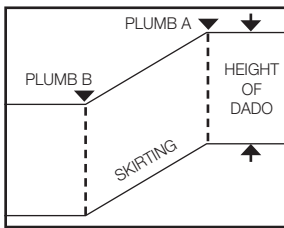

- 1 Few walls are truly square or perfectly vertical, so it is therefore important to avoid the pattern running out. Mark a vertical line (A) using a plumb line at the top of the stairs as shown. If no rail is installed mark a further vertical line (B) at the bottom of the stairs and mark another line between A and B as a trimming guide.

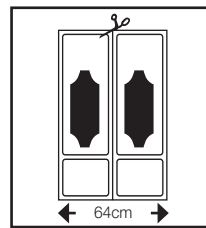

- 2 A standard panel is 64cm in width and made up of 2 or 4 sub panels. On stairs half panels should be used, cut at 32cm widths as in figure 3.

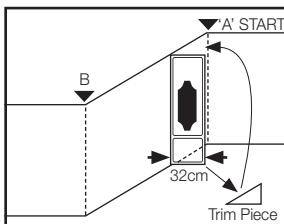

- 3 Start at the top 'A' and hang the first 32cm half panel vertically. Trim the bottom of the panel carefully at the skirting and use the offcut to fill in at the top of the panel. NB: By starting the whole project at 'A' you will ensure the last 1/2 panel used on the stairs can be correctly trimmed at the bottom of the stairs.

Consumer helpline +44 (0) 1427 616597

Retford Wallcoverings Ltd, Unit 28, Corringham Road Industrial Estate, Gainsborough, Lincolnshire DN21 1QB